

# the Blueprint

ARIA GROUP ARCHITECTURE + design

## Design that delivers.

Creating memorable experiences in hospitality  
that inspire, connect, and perform

### FEATURES

*The DöRR Hotel*

*Topgolf*

*One Small Snack*

*Amy's Drive Thru*

*Supercharged*

*Shake Shack*

*Cooper's Hawk*

*Perry's Steakhouse & Grille*

### PLUS

*Team Member Personals*

*Photos: A Year in Review*

*and How well do you know Aria Group?*



# Highlights of 2021

The past year has been a testament to our firm's resilience and agility to pivot quickly—for our people and our clients. Through our new hybrid scheduling model, our staff works seamlessly to develop new concepts, build brands, meet deadlines, and collaborate with clients as they grow. Keeping an eye on our client's bottom line, being responsive when things change, and pushing the limits of innovative design, our focus is design that delivers—every time. -Jim Lencioni, President

**on the cover:**  
Brass on custom venetian plaster at Perry's Steakhouse & Grille, Dallas, TX.  
Photo by Eva Toma



## Features

03

### Personals

All that's new with Aria Group. We have many new and familiar faces back with us!

04

### The DöRR Hotel

We got our "hygge" on designing the interiors for a new boutique hotel in Door County.

06

### Perry's Steakhouse & Grille

An updated brand program keeps the vibe distinct and strong through expansion.

08

### Shake Shack

Check out the exciting new elements for the brand's digital evolution.

09

### One Small Snack

A bite-sized kiosk making a big impact in Chicago's renowned science museum.

10

### Amy's Drive Thru

Our inaugural partnership with the well-known organic and sustainable brand was a success.

I2

### Topgolf

Fresh, open-air design elements add a new twist to this sports entertainment powerhouse.

I4

### Cooper's Hawk

Bringing handcrafted wine and modern casual dining out West to the desert.

I6

### Supercharged

The second East Coast location for the world's largest multi-level karting track.

I7

### On the Boards + Opened Up

A peek at what we have in the works and what's about to open their doors.

I8

### Our Year in Review

We're more than coworkers- we're friends. A photo recap of fun throughout the year.

I9

### How well do you know Aria Group?

See if you can complete the crossword puzzle!

# Personals

## New Hires in 2021



## Familiar Faces

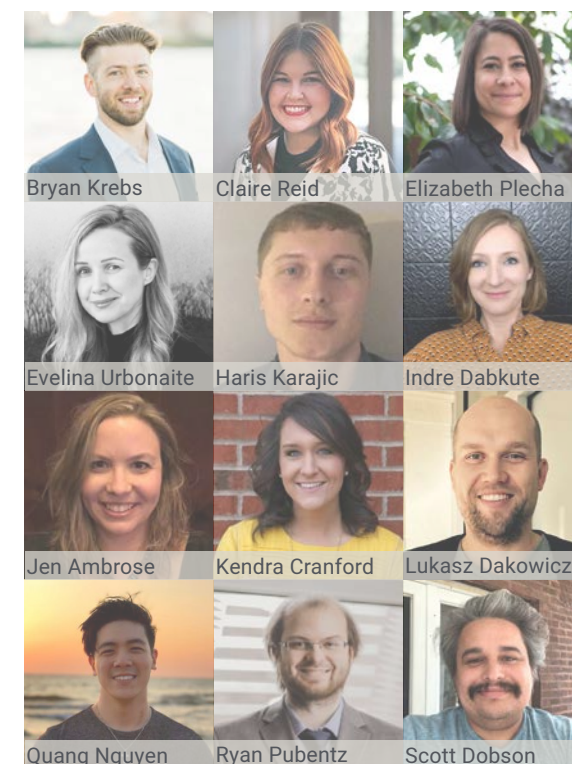

## Congratulations are in order:

### Promotions

#### Project Manager

Matt Shoener  
Sean Irish  
Damian Satola

#### Project Coordinator

Shellie Halkyard  
Kyle Miller  
Lauren Wissman

#### Senior Architectural Designer

Olga Ratajski  
Sana Ahmad

### Awards & Recognition

#### IIDA Red Award in Hospitality:

Restaurant | True Food Kitchen Las Vegas

#### Rated Interior Design Magazine's

#2 on the list of Rising Giants

#### Honorable Mention

Architect's Newspaper AN Awards  
Unbuilt Interior for project Illume

### Licensures

Andrew Leung, AIA  
Erinn Lyons, NCIDQ

### New Arrivals

Audrey Greubel baby girl Emily 5/28/21  
Neal Thompson baby boy Luke on 5/29/21  
Dunja Jovanovic baby girl Lena on 10/8/21



# The DöRR Hotel

Sister Bay, Wisconsin | Opened June 2021

Located in the heart of Door County Wisconsin, The DöRR Hotel combines contemporary charm with natural Nordic simplicity. The design of this boutique hotel is inspired by the area's Scandinavian heritage and creates an experience that brings people and seasons together. The warm and inviting ambiance creates an intimate getaway for guests to stay. The ultimate in

'hygge' - a Danish term meaning 'coziness' - the hotel features 47 well-appointed guest rooms and suites with features like a bay-facing balcony and thoughtful in-room amenities. -Trina Alsip, NCIDQ



**Project Team** Hunter McCalla, Interior Designer • Claire Reid, Interior Designer • Trina Alsip, Senior Designer • Eva Toma, Senior Designer • Tina Clemens, Project Coordinator • Matt Clarke, Project Manager • Frank Cavanaugh, Principal



**Rooms** 47, including 8 suites  
**Square Footage** 42,500  
**Contractor** Bayland Buildings Inc.  
**Photographer** Ballogg Photography  
**Base Building** ZWA Architecture







**Above** Sugar Land, TX **Lower Left** Sugar Land, TX  
**Lower Right** Sugar Land, TX



**Location** Schaumburg, IL (shown right)  
**Seats** 347  
**Square Footage** 12,500  
**Contractor** International Contractors, Inc.  
**Photographer** Steve Chenn

# Perry's Steakhouse & Grille

Brand Evolution | Multiple Locations

Over the course of our near decade-long partnership, we have had wonderful opportunities to build, evolve, and strengthen the Perry's Steakhouse & Grille brand alongside their team. Since 2020, the focus has been to incorporate a design evolution that includes distinct ownable elements, fixtures, and furniture that convey an immediate Perry's "look and feel" while acknowledging the vibe and individuality of each location and new market. Through these detail refinements, we have thoughtfully shifted both urban and suburban models to

incorporate meaningful moments that allow the Perry's guest to have the "rare experience" while visually moving the aesthetic in a modern direction. Details like custom venetian plaster with brass inlay, decorative screen panels, natural mounted longhorns, thoughtfully deconstructed lighting designs, a stunning material palette and an iconic bar display - all continue to collectively differentiate the brand and bring guests back for more. - *Eva Toma*



**Project Team** Erinn Lyons, Interior Designer • Hunter McCalla, Interior Designer • Paul Nagtalon, Architectural Designer • Adam Tregoning, Architectural Designer • Eva Toma, Senior Designer • Megan Walsh, Project Designer • Brian Zielinski, Project Manager • Walter Pancewicz, Principal



# Shake Shack

Polaris, Ohio | Opened November 2021



Leading the world of fine casual, the modern community gathering vibe Shake Shack is known for has been enhanced with several "Shack Track" convenience features. In addition to digital pre-ordering, app-driven

drive-up and walk-up windows, multi-channel pickup shelving, self-order kiosks, and order status screens, we infused a bright, light-filled palette with the brand's iconic angles and dynamic seating styles. With the core design philosophy retained, the innovations are seamlessly integrated and elevate the brand. - Sara Armeanu



Renderings

**Project Team** Sara Armeanu, Interior Designer • Andrew Cunningham, Architectural Designer • Douglas Lueken, Project Coordinator • Archit Sawhney, Project Designer • Neal Thompson, Project Manager • Thomas Smiciklas, Principal

**Seats** 108  
**Square Footage** 1,700  
**Contractor** Coastal Quality Construction, Inc.  
**Renderings by** Sara Armeanu



# One Small Snack

Museum of Science and Industry | Chicago, Illinois | Opened December 2021

The inspiration for the museum's new snack café came from the surrounding outer space exhibit, which is also home to a moon rock sample. The terrazzo POS system island, along with brushed nickel finishes throughout, elevate the space to embody its intergalactic environment. The digital ceiling panels are finished in a blue onyx print that provide a fascinating aspect within

the café. This design features custom island millwork, striking soffits and inspired lighting. Up next: Aria Group is currently designing the new food court that includes five different vendor stations as well as a new cafe space. - Archit Sawhney, AIA



**Square Footage** 1,200  
**Contractor** Happ Builders Inc.  
**Photographer** Tony Soluri



**Project Team** Sara Armeanu, Interior Designer • Nathan Kiecker, Architectural Designer • Guillermo Gomez, Project Coordinator • Archit Sawhney, Project Designer • Neal Thompson, Project Manager • Thomas Smiciklas, Principal



**Seats** 85 interior | 50 patio  
**Square Footage** 4,380  
**Contractor** KDC Construction  
**Photographer** Cesar Rubio



# Amy's Drive Thru

Roseville, California | Opened December 2021



Aria partnered with Amy's Drive Thru to create a building that highlights their commitment to sustainability, utilizing natural materials, daylighting, living roof, and solar energy. Visitors to the restaurant can experience both indoor and outdoor dining while enjoying organically sourced and prepared food. The use of a living roof functions both as brand identity and provides thermal properties

for the building. The exposed wood trusses, natural rock walls, and repurposed antique car overflowing with plants bring attention to the company's agrarian roots. Amy's Drive Thru, a B Corp Certified restaurant, strives to be considerate of its business' impact on its workers, customers, the community and the environment. Roseville is one of four locations Aria Group has worked on with Amy's to expand the brand along the West coast. - Lauren Wissman

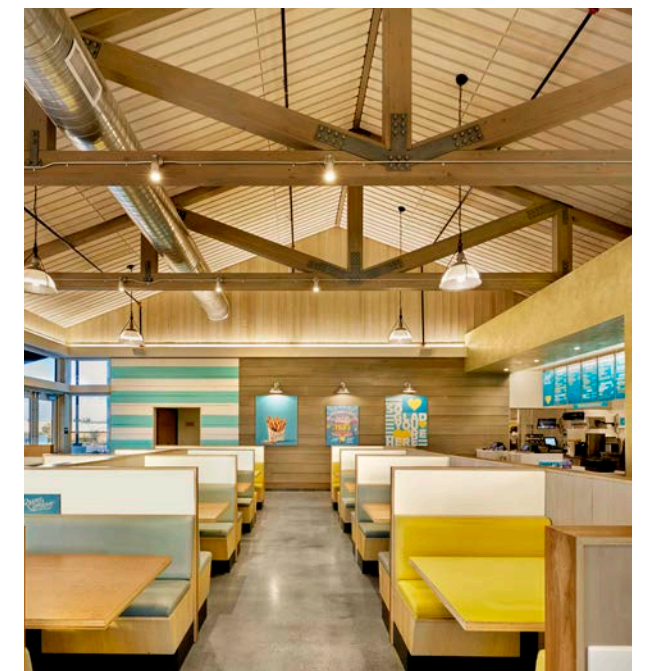

**Project Team** Yaskira Camacho, Architectural Designer • Lauren Wissman, Project Coordinator • Joe Junius, Project Designer • Kristin Mrozinski, Project Manager • Frank Cavanaugh, Principal • Additional support from Lillian Reyes Brahar, Indre Dabkute & Shana Albazi



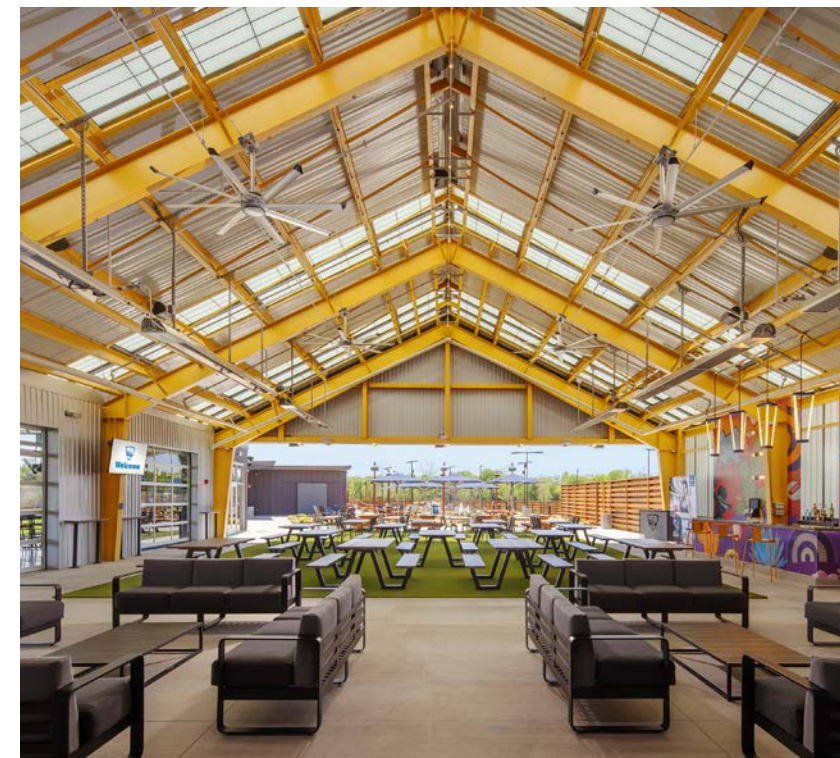

**Location** Waco, TX  
**Seats** 531  
**Square Footage** 34,000  
**Contractor** ARCO/Murray  
**Photographer** Michael Baxter

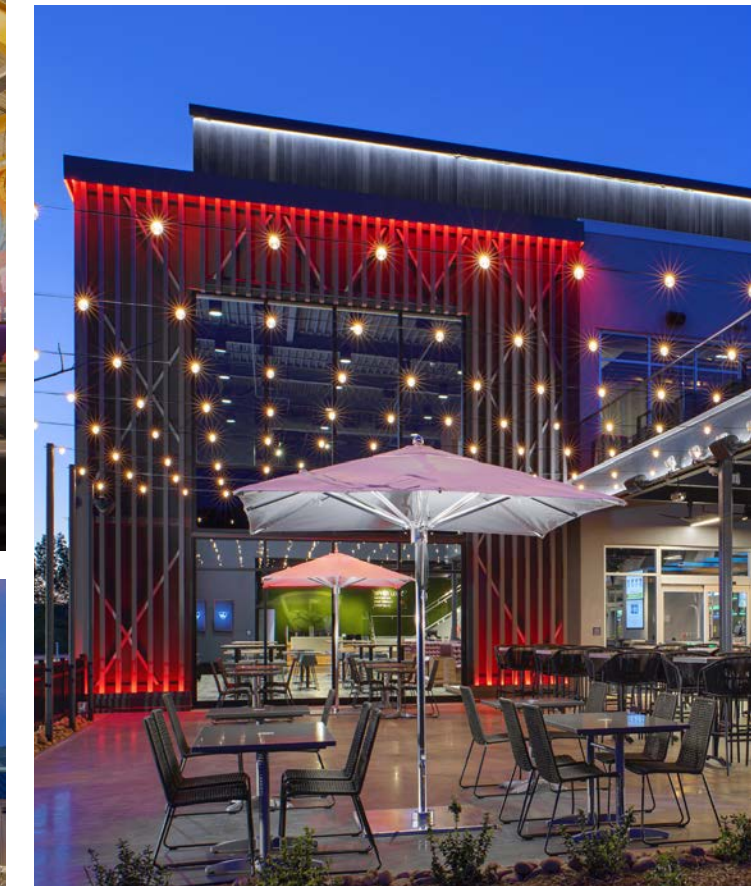

**Top Left** Buford, GA **Center** Waco, TX **Top Right** Buford, GA **Below** Waco, TX **Opposite** Buford, GA

# Topgolf

Open-Air and Two-Story Concepts | Multiple Locations



Our longtime partner, Topgolf, was ready to develop an exciting new single-story concept that could be tailored for emerging markets nationwide and the flexible, open-air concept was born. The Waco, Texas venue is one of the first of its kind for the model where local community and energetic, outdoor elements take center stage in the design for this incredibly popular sports entertainment brand.

Equipped with fire pits, large picnic table seating, lawn games—and even mini golf—this flexible design and open concept floor plan facilitates large groups and families as they experience the

overlapping gathering spaces moving indoors and out. This community-centric program is also characterized by the large bar that greets guests and leads straight into the classic Topgolf hitting bays and impressive outfield.

The physical and digital platforms will continue to push the boundaries for Topgolf as the design components, programming features, and integrated technologies make the game-like experience both sophisticated and unique for all. Up next for the powerhouse brand is an exciting hybridized model rolling out this year that continues to make socializing a sport and the game of golf exhilarating to a wide-range of new and avid guests.

- *Damian Satola, AIA*

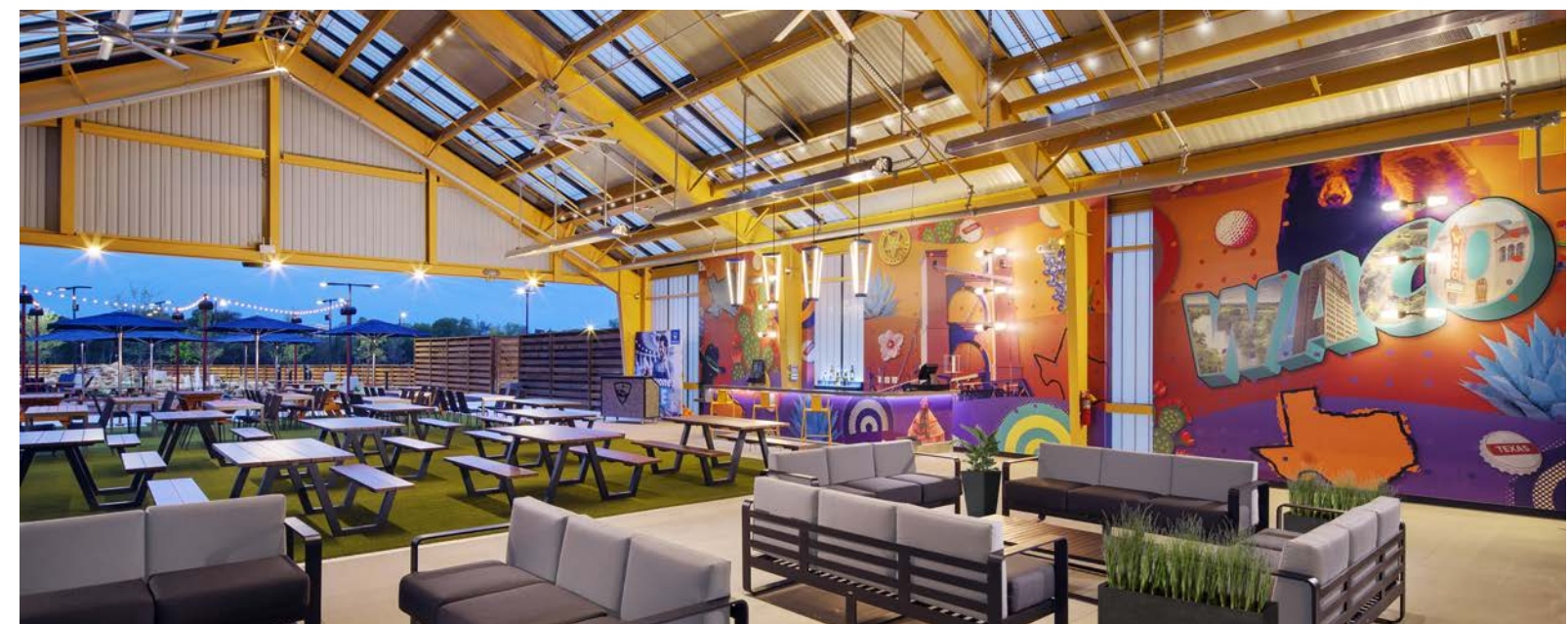

**Project Team** Liliana Borchers, Architectural Designer • Martin Kurdaliev, Architectural Designer • Olga Ratajski, Senior Designer • Sana Ahmad, Senior Designer • Andrew Leung, Project Coordinator • Archit Sawhney, Project Designer • Damian Satola, Project Manager • Thomas Smicklas, Principal





# Cooper's Hawk

Winery & Restaurants | Scottsdale, Arizona | Opened May 2021

The new Cooper's Hawk in Scottsdale is the first of this brand's restaurants in Arizona. Located not far from several of Frank Lloyd Wright's designs, the city had requested that the building design incorporate elements of the famous architect's Prairie style. A

deconstructed FLW motif was brought through the exterior design in the use of metal louvers/screens for shading the desert sun, along with horizontal building massing.



This motif was repeated several times on the interior as well through the ceiling design and screening elements. Additionally, this design was inspired by the natural Arizona landscape through the use of warm decorative lighting, limestone, rust tones, teal, and green, and wood tones.

- Elizabeth Kozlik, NCIDQ

**Seats** 287 Indoor | 104 Outdoor

**Square Footage** 11, 223

**Contractor** International Contractors, Inc.

**Photographer** Paul Markow



**Project Team** Emma Phillips, Interior Designer • Stacey Bouwman, Senior Designer • Ana Hernandez, Project Coordinator • Elizabeth Kozlik, Project Designer • Dan Bernatek, Project Manager • Joe Vajda, Principal



# Supercharged

Edison, New Jersey | Coming Fall 2022



Supercharged is expanding to open a second location and returned to partner with Aria Group! This entertainment concept currently has the largest multilevel karting track in the world at their first location in Massachusetts. The coming New Jersey locaton will not only feature the

synonymous go-kart racecourse, but will also be home to amusement rides, a bumper car arena, and two levels of arcade games. Using their signature color palette, the brand has evolved for this new project site with bold patterns, metals, and an energetic lighting design throughout. In addition to the gaming spaces, Aria Group was chosen to develop the bar-restaurant concept within the facility. -Kendra Cranford



**Project Team** Kendra Cranford, Interior Designer • Ndeye Fatou Daikhate Nije, Architectural Designer • Shannon Sterne, Project Designer • Mark O'Henley, Project Manager • Joe Vajda, Principal



**Square Footage** 127,000  
**Renderings by** Kendra Cranford  
**Base Building** Studio S Architecture



# On the Boards + Opened Up

Sunny Bowls



theMART Chicago, IL  
Opened August 2021

Tortazo by Rick Bayless



New York, NY  
Opened October 2021

16th Street Shared Kitchen



Chicago, IL  
Opening 2022

Del Frisco's Double Eagle Steakhouse



Pittsburgh, PA  
Opening 2022

Hell's Kitchen by Gordon Ramsay



Multiple Locations  
Opening 2022 & 2023  
\*Rendering shows new exterior finishes applied to existing building shell

Mastro's Steakhouse



Santa Clara, CA  
Opening 2022

Quartino



The Colony, TX  
Opening 2023

Alter Brewing



Oak Brook, IL  
Opening 2022

Tangled Roots



Washington, IL  
Opening 2023



# Our Year *in Review*

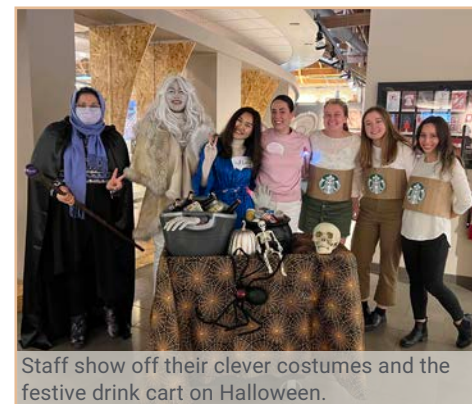
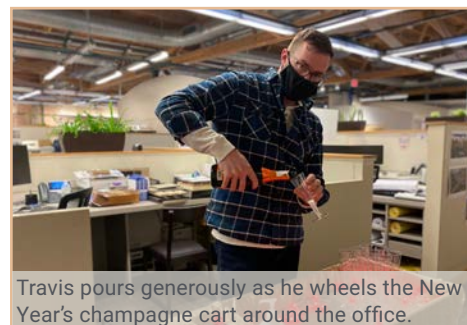
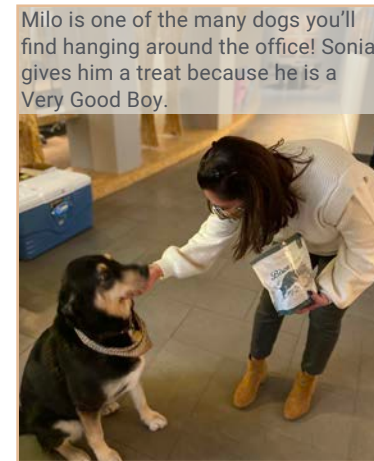
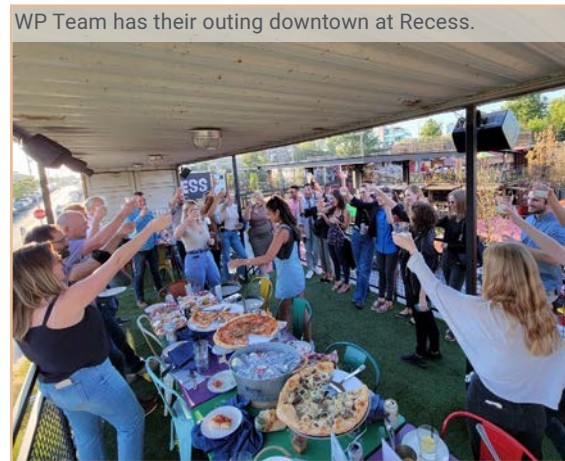
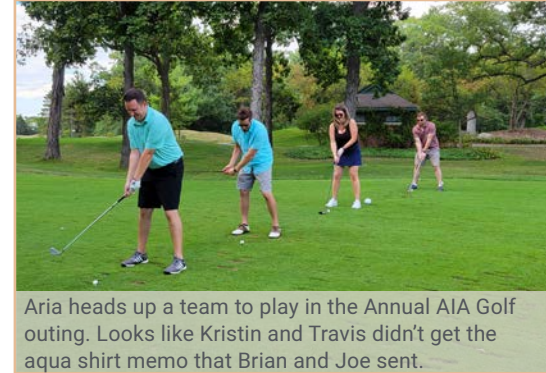

# How well do you know *Aria Group*?

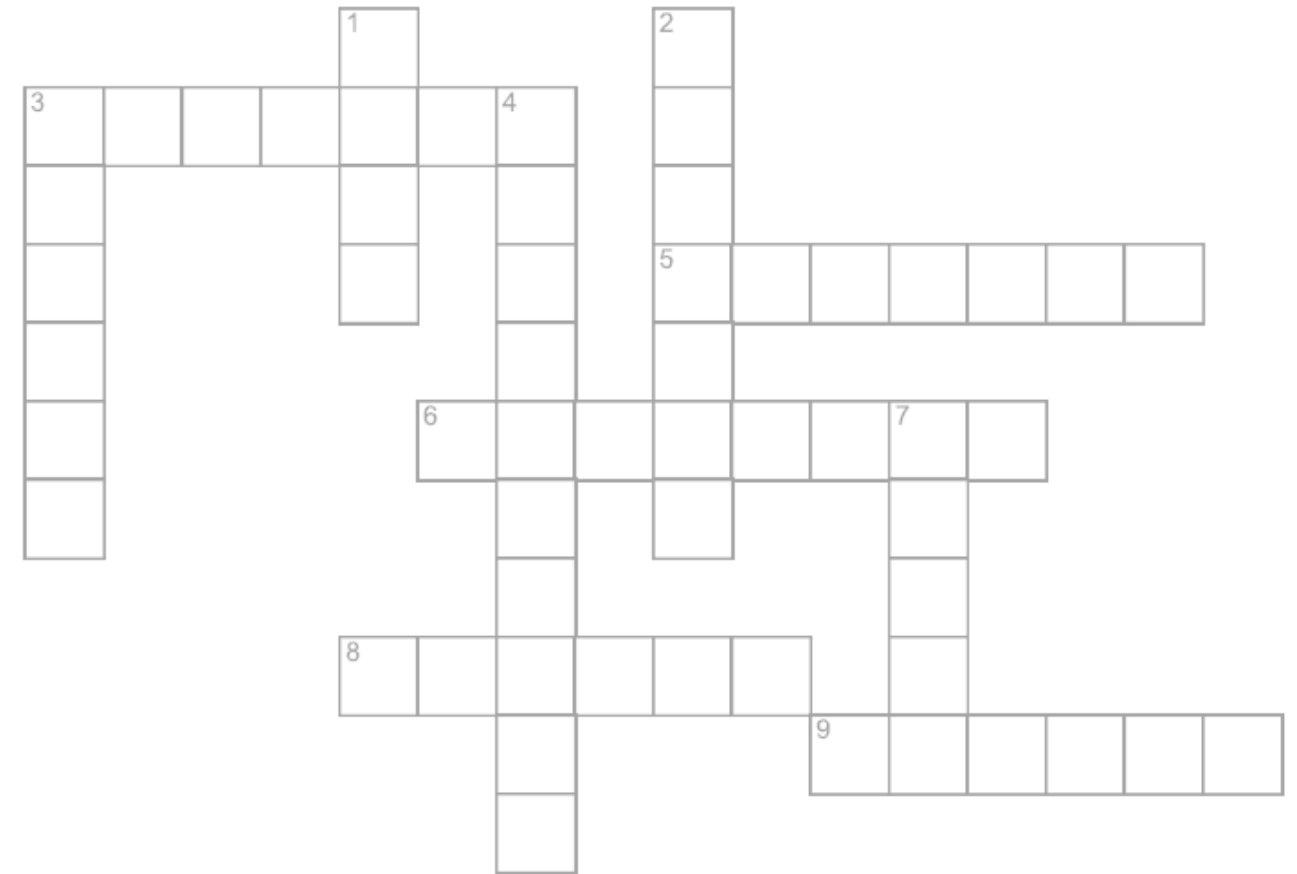

Down

- 1 The late beloved Doggie Mascot of Aria Group.
- 2 Aria Group's first multi-unit account (first word of 3-part name).
- 3 Aria Group's signature metallic brand color.
- 4 This client came to Aria Group in 2010, who started as a hot dog stand out of Madison Square Park in NYC.
- 5 The first Aria Group project in the Northeast.
- 6 The first Aria Group project in the Midwest.
- 7 You can find Aria Group's current office on \_\_\_\_ Boulevard in Oak Park, IL.

### Across

- 3 This client serves wine lovers in over ten states across the country (first word of name).
- 5 This golf-centric client originated in the United Kingdom before coming to the US in 2005.
- 6 President of Aria Group, last name.
- 8 Aria Group moved to their first Oak Park office in 1992 inside The \_\_\_\_ Building.
- 9 In 2019, Aria Group celebrated this many years in business with a trip to Punta Cana (in letters).





**Aria Group Architects, Inc.** 830 North Blvd Oak Park, IL 60301



**Principals** Jim Lencioni, Walter Pancewicz, Joe Vajda, Thomas Smiciklas, Frank Cavanaugh, Christopher DeBoer



**Senior Associates** David Nash, Dan Bernatek, Chris Hamer, Megan Walsh



**Associates** Matthew Clarke, Elisabeth Battle, Neal Thompson, Joe Junius

**This issue created by** Catie Crutchfield, Sara Armeanu, Lauren Wissman, Angela Spinillo, & Eva Toma